

# ATLC CONNECTOR

Board-to-wire

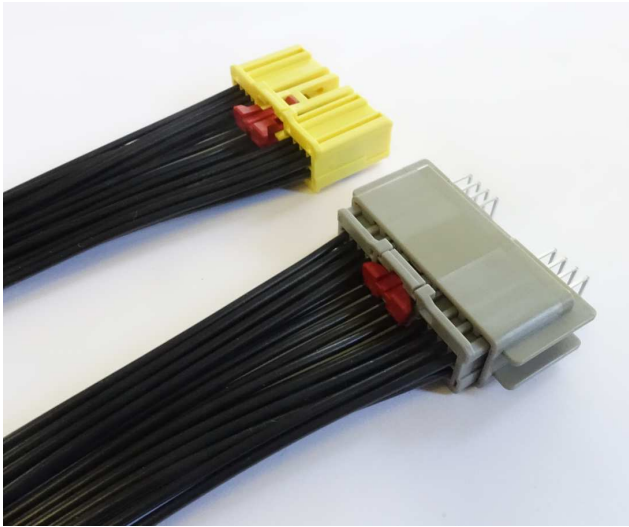

## ■ Features

- 21 Circuits: 0.64 Unsealed Connector
- Independent Secondary Lock Terminal Position Assurance (ISL TPA)
- Connector Position Assurance (CPA)
- Unique PCB mounting, Ultra-low profile side entry design
- Additional keying options with customised header options (not shown)
- For Automotive Applications

21 Circuits 0.64 Unsealed Connector System with CPA and ISL TPA. Ultra-low profile design for high density PCB placement.

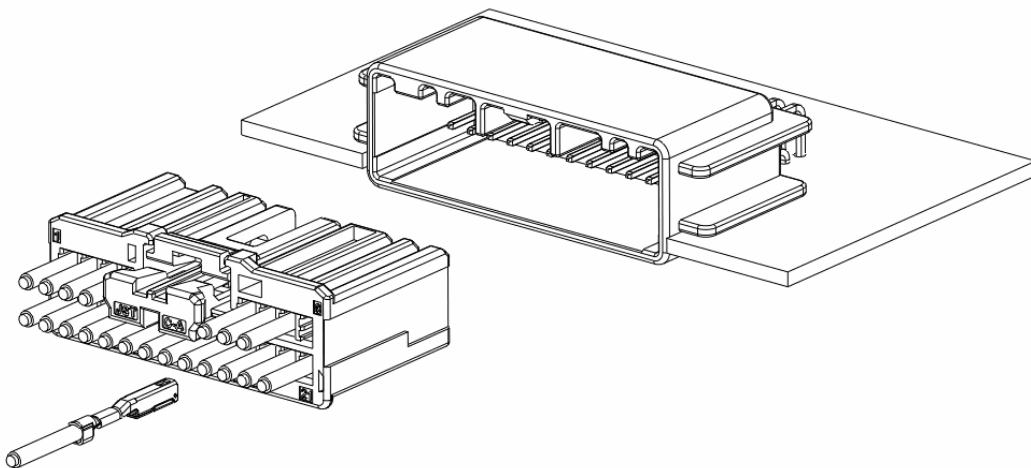

## ■ Specifications

- Current rating : 7 A DC (0.75mm<sup>2</sup>)
- Voltage rating : 14 V DC
- Temperature range : -40°C to +125°C  
(including temperature rise in applying electrical current)
- Contact resistance : Initial value/ 15 mΩ max.  
After environmental tests/ 15 mΩ max.
- Insulation resistance : 100 MΩ min.
- Withstanding voltage : 1,000 VAC /minute
- Applicable wire : ISO  
0.35mm<sup>2</sup> to 0.75mm<sup>2</sup>  
(Insulation O.D. 1.9mm max)

\*Compliant with ELV/RoHS2.

\*Contact JST for details.

## Female Terminal

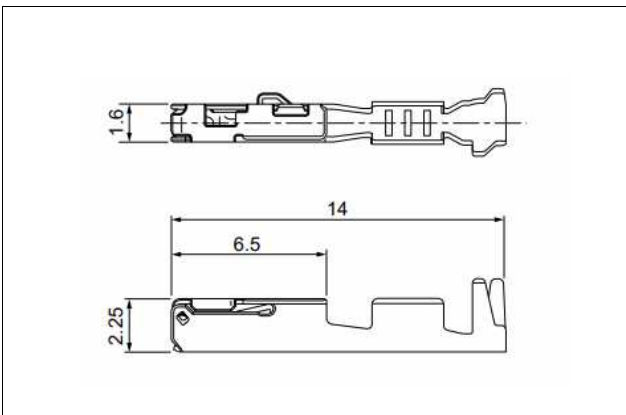

Model No.	Applicable wire range		Q'ty/reel
	Conductor (mm <sup>2</sup> )	Insulation O.D. (mm)	
<b>SAIT-A03T-M064</b>	0.35 to 0.5	≤1.9	6,500
<b>SAIT-A02T-M064</b>	0.75	≤1.9	6,500

### Material and Finish

Copper alloy, tin-plated (reflow treatment)

## Female Connector

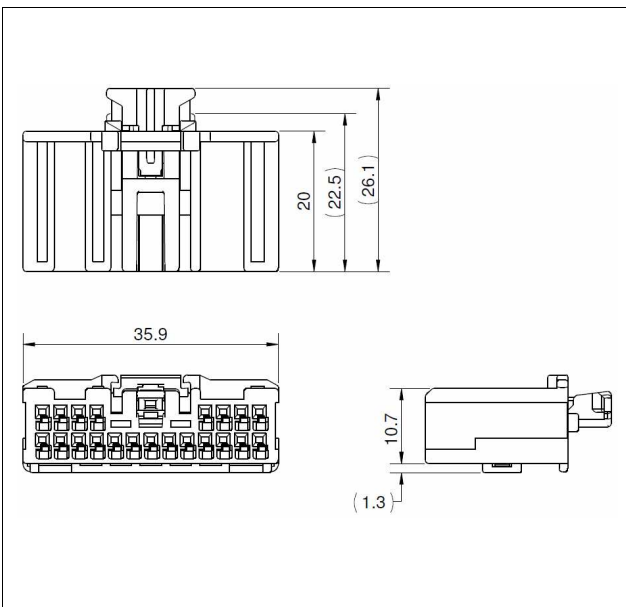

Circuits	Model No.	Key Code	Housing Color	TPA Color	Q'ty/box
21	<b>ATLCPB-21B-2AY</b>	A	Yellow	Black	1,000
	<b>ATLCPB-21B-2BH</b>	B	Gray	Natural	1,000

### Material and Finish

Housing: PBT  
 TPA: Glass-filled PBT  
 CPA: Glass-filled PBT, Red

## Male Connector

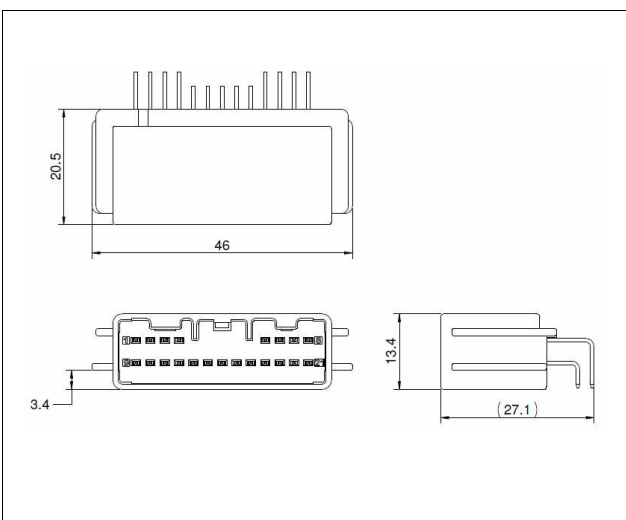

Circuits	Model No.	Key Code	Housing Color	Q'ty/box
21	<b>S21B1-ATLC-2BH</b>	B	Gray	700

### Material and Finish

Housing: Glass-filled PBT  
 Pin: Brass, tin-plated

## PC Board layout, Assembly layout

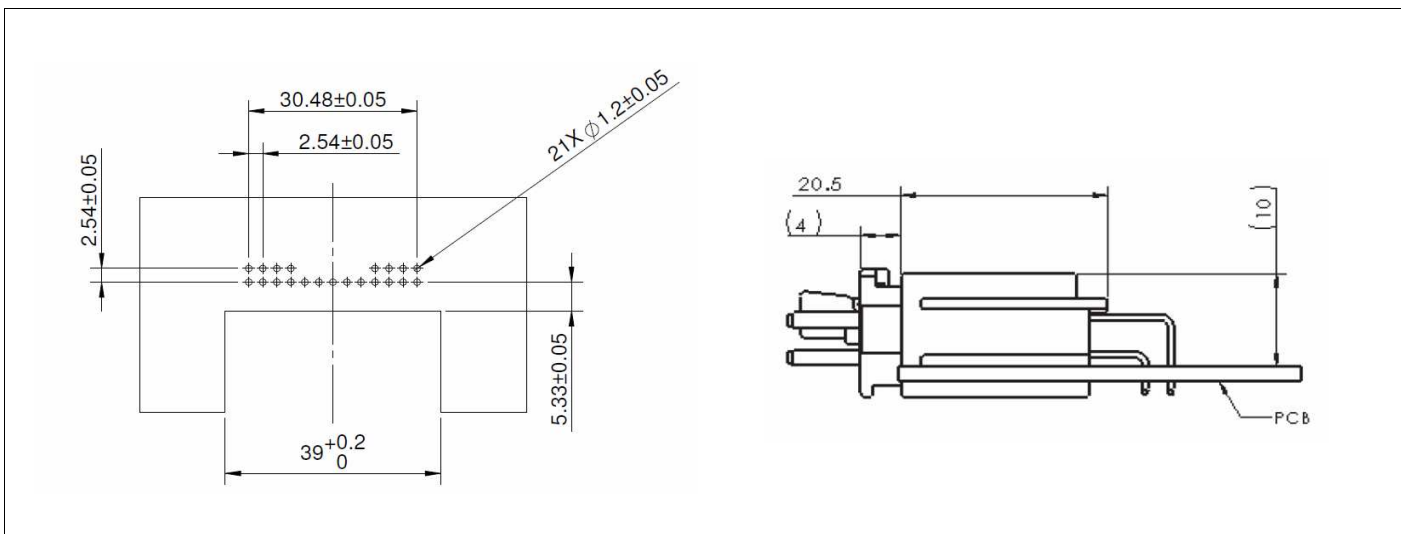

## Crimping machine, Applicator

Strip terminal	Crimping machine	Crimp applicator MKS-L	
		Dies	Crimp applicator with dies
<b>SAIT-A03( )-M064</b>	AP-K2N	MK/SAIT-A03-064	APLMK SAIT-A03-064
<b>SAIT-A02( )-M064</b>		MK/SAIT-A02-064	APLMK SAIT-A02-064

Note: 1. Contact JST for details.

2. When crimping operation is conducted using an applicator and die set other than the above, JST cannot guarantee the performance of the terminal.